

# Imperial Convertor

Quickly and easily converts metric MDPE pipe to imperial pipe sizes

## Overview

Speedfit Imperial Convertor is used to convert metric size MDPE fitting for use with imperial size LDPE to BS1972 Class C or Class D. Supplied with inch size Pipe Insert. The Stem cannot be disconnected from mating connector with a collet cover fitted.

Designed, manufactured and assembled in the UK.

## Features & Benefits

- Instant push-fit connection and screw down mains stop valve
- Install and demount in seconds without tools
- Stainless steel teeth grab ring provides extra grip on the pipe
- Durable material with high impact resistance
- Non-toxic and no scale build-up
- Resists corrosion and biological growth
- Compatible with MDPE pipes only (inserts provided)
- Suitable for cold water use only



Product code	Description	Stem	Pipe	Bag QTY
UGICO1	Cold Water Service Imperial Convertor	20mm	1/2"	1
UGICO2	Cold Water Service Imperial Convertor	25mm	3/4"	1

## Working parameters & specifications

Application	Usual working temperature °C	Maximum working temperature °C	Maximum working pressure, bar
Cold Water (indirect and direct mains)	20	20	16

## Materials

Body	Acetal Copolymer (Unfilled), Blue
Collet Cover	Acetal Copolymer (Unfilled), Blue
Collet	Acetal Copolymer (Unfilled), Blue & Stainless Steel
O-Ring	EPDM
Insert	Acetal Copolymer (Unfilled), Grey

## Dimensions – All measurements in mm unless otherwise stated

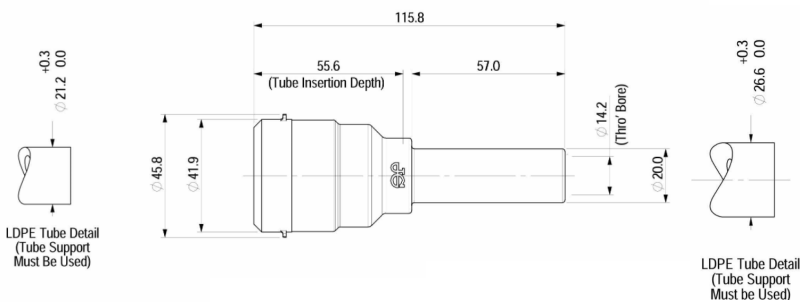

UGICO1

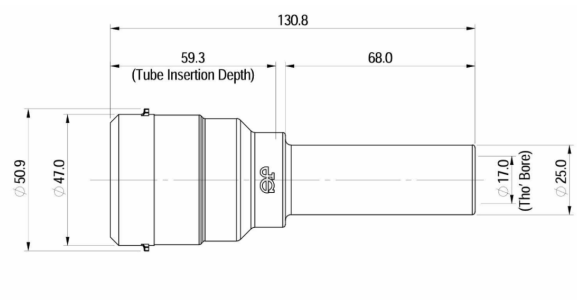

UGICO2

