

# Slip Connector

Repairs damaged pipe easily, particularly in confined spaces, slip end allows flexible adjustment

## Overview

Speedfit plastic push-fit fittings used to easily and quickly repair damaged pipe with a slip end connection for flexible adjustment. Simply push the fitting fully onto plastic or copper pipe. To demount the connection, push the collet towards the body of the fitting and pull the pipe to release.

The fitting is up to 40% faster to install than traditional methods and is easier to use in confined spaces by removing the need for hot works and tools.

Designed, manufactured and assembled in the UK.

## Features & Benefits

- Instant push-fit connection
- Install and demount in seconds without tools
- Safe flame-free installation, with no hot works, glue or flux
- Grip & Seal collet with stainless steel teeth and main O-Ring seal
- Non-toxic, resists corrosion and no scale build-up
- Suitable for use with JG Speedfit PEX and polybutylene barrier pipe (inserts required) and copper pipe
- Suitable for hot and cold water only (not suitable for central heating systems)



Product code	Description	Size	Bag QTY
CM-SC-15S	Slip Connector	15mm	10



50 year guarantee when used with JG Speedfit Layflat PB and PEX Barrier Pipes

# Slip Connector

## Working parameters & specifications

Application	Maximum working, temperature °C	Maximum working pressure, bar
Cold Water (indirect and direct mains)	20	12
Hot Water (including unvented cylinders)	65	6

## Materials

Body	Acetal Copolymer (Unfilled), Light Grey
O-Ring	Ethylene Polypropylene Diene Monomer (EPDM)
Collet	Acetal Copolymer (Unfilled), Dark Grey
Collet Teeth	Stainless Steel 301
Release Ring	Acetal Copolymer (Unfilled), Natural

## Dimensions – All measurements in mm unless otherwise stated

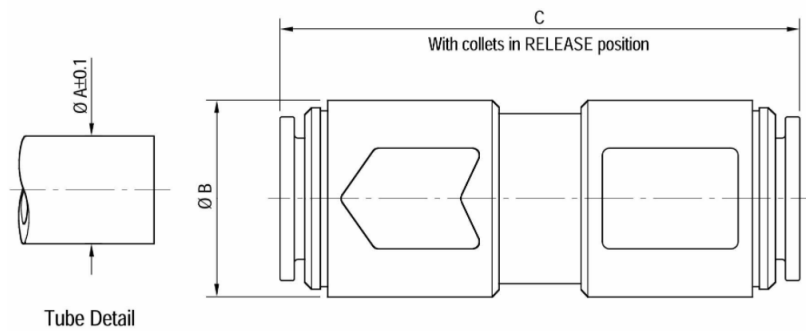

Product No.	Dim A	$\varnothing B$	C
CM-SC-15S	16.0	27.4	70