

Reducer

Working parameters & specifications

Application	Maximum working pressure, bar
Air	16 Bar

Materials	
Body	Plastic
O-Ring	Nitrile, Black
Collet	Acetal Copolymer (Unfilled), Black
Collet Teeth	Stainless Steel 301

Dimensions – All measurements in mm unless otherwise stated

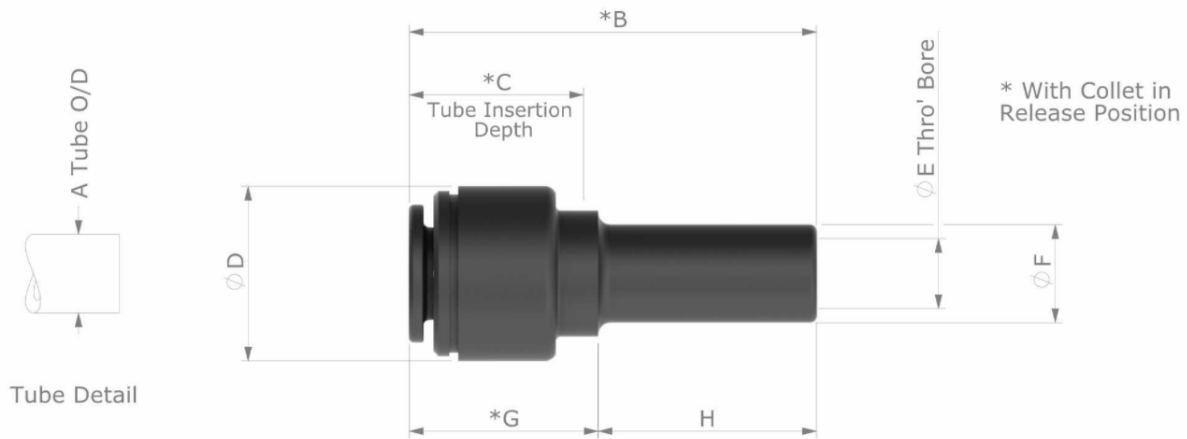

Product No.	Description	A - Tube O/D	B	C	ØD	ØE	ØF	G	H	
PM060504E	5mm Stem - 4mm Tube O/D	4.0	+0.05/-0.07	34.6	14.3	13.0	2.5	5.0	18.1	16.5
PM060604E	6mm Stem - 4mm Tube O/D	4.0		36.3	14.3	13.0	2.5	6.0	18.3	18.3
PM060605E	6mm Stem - 5mm Tube O/D	5.0	36.1	14.3	13.0	3.4	6.0	18.1	18.0	
PM060804E	8mm Stem - 4mm Tube O/D	4.0	37.2	14.3	13.0	3.5	8.0	18.1	19.1	
PM060805E	8mm Stem - 5mm Tube O/D	5.0	37.2	14.3	13.0	3.4	8.0	18.1	19.1	
PM060806E	8mm Stem - 6mm Tube O/D	6.0	37.4	15.7	15.0	4.8	8.0	18.3	19.1	
PM061006E	10mm Stem - 6mm Tube O/D	6.0	40.5	15.7	15.0	4.8	10.0	18.3	22.2	
PM061008E	10mm Stem - 8mm Tube O/D	8.0	40.4	16.7	17.8	6.3	10.0	18.2	22.2	
PM061208E	12mm Stem - 8mm Tube O/D	8.0	40.5	16.7	17.8	6.3	12.0	18.2	27.5	
PM061210E	12mm Stem - 10mm Tube O/D	10.0	50.0	19.7	19.8	7.6	12.0	22.5	27.5	
PM061510E	15mm Stem - 10mm Tube O/D	10.0	55.3	19.7	19.8	7.6	15.0	22.6	32.7	
PM061512E	15mm Stem - 12mm Tube O/D	12.0	60.2	25.9	23.0	9.1	15.0	27.7	32.5	
PM061815E	18mm Stem - 15mm Tube O/D	15.0	70.5	28.7	26.7	12.1	18.0	34.4	36.1	
PM062215E	22mm Stem - 15mm Tube O/D	15.0	69.6	27.8	27.0	12.1	22.0	33.5	36.5	
PM062218E	22mm Stem - 18mm Tube O/D	18.0	71.6	31.0	31.1	16.0	22.0	35.5	36.1	

Dimensions in mm