

Stem to Tube Adaptor Metric to Imperial

Quickly and securely convert a push-fit connection to imperial or metric sized stem connection

Overview

John Guest push-fit Stem to Tube Adaptor Metric to Imperial is a fitting designed for converting imperial or metric pipework to a stem type connection. Fast and simple to install, John Guest push-fit fittings create an instant push-fit connection and leak tight seal without the need for tools, hot works or sealing agents.

The unique collet locking design firmly and securely holds the pipe in place without deforming the pipe or restricting flow. Fittings are corrosion resistant and fully demountable, improving system performance and reducing system downtime during maintenance.

Engineered to the highest quality, the fitting is suitable for foodstuff, potable liquids and inert gases. In accordance with the British Beer & Pub Association Code of Practice, fittings can also be used with N2/CO2 and mixed gas dispense lines, as well as air, pneumatic and vacuum applications. All John Guest fittings are manufactured and assembled in the UK.



Features & Benefits

- Suitable for use with non-toxic food grade material, potable liquids and inert gases
- Safe and secure push-fit connection
- Connect disconnect and reconnect in seconds without tools
- No scale build up improves performance and equipment lifespan
- Superior flow characteristics

Product Code	Description	Size
NC2164	Stem to Tube Connector	15mm - 3/8"
NC2173	Stem to Tube Connector	1/2" - 15mm



Stem to Tube Adaptor Metric to Imperial

Application	Maximum working temperature °C	Maximum working pressure, bar
Potable Water	20	10
Intermittent Hot Water	60	4

Materials	
Body	Acetal Copolymer
O-Ring	EPDM
Collet	Acetal Copolymer
Collet Teeth	Stainless Steel 301

Application
Potable Liquid
Water Treatment & Purification
Inert Gases
Vacuum

Dimensions – All measurements in mm unless otherwise stated

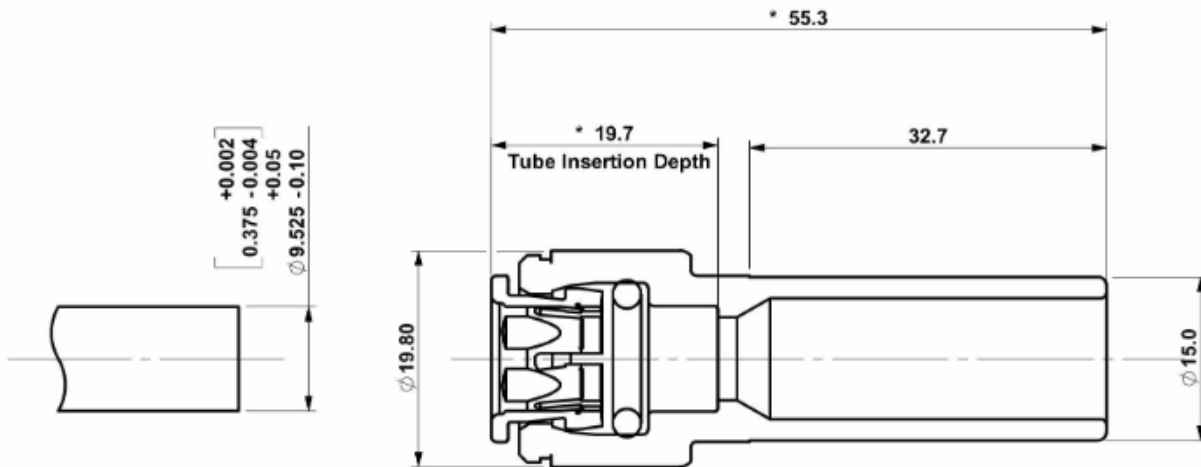

Tube Detail

* With Collet in Release Position